

BENTLEY MK. VISECTION FC L U T C H .

Containing:-

- GROUP 1 CASING CLUTCH
 2 CLUTCH
 3 LINKAGE
 4 PEDAL
 5 TRUNNION AND CROSS SHAFT

KEY TO CHASSIS NUMBERS

Used on	A.B.C.D.E.F.G Series	= F
" "	B-HR 2 onwards	= G
" "	A.B.C.D.E.F.G. Series	= H
" "	H.J.K. Series	
" "	B-LJ 2-298	= J
" "	B-LJ 300 onwards	= K
" "	A.B.C.D.E. Series	
" "	B-FV 2-100	= L
" "	B-FV 102 onwards	= M
" "	H Series onwards	= N

GROUP F1. CLUTCH CASING

Comprising

BOLT, 3 BA, seal, cover bottom	X. 8	K 3602/Z	6	
BUSH, anchor pin	1	GB 4751	1	
BUSH, threaded, supply valve elbow (RC)	2	RF 6780	2	
CASING, main assembly, (when breather plate is fitted) consisting of	3	GB 4333A	1	
Adaptor, shaft bearing oil supply		GW 952	1	
Bush, cross shaft bearing		GW 946	1	
Casing		GB 4333	1	
Pin, anchor		GB 4760	1	
Rivet, .125" dia., timing pointer	X.40	KB 1850	2	
Pointer		RE 6324	1	
Stud, 2 BA, timing pointer inspection cover	X.60	KB 3818/Z	1	
Stud, 2 BA, breather	X.60	KB 3818/Z	3	
Stud, .250" dia., bottom cover	X.65	KB 3823/Z	6	
Stud, .312" dia., gearbox facing	X.73	KB 405/Z	8	
Washer, Welch, shaft bearing bore		RG 3250	1	
CASING, main assembly, (when rubber plug is fitted) (RC) as above, except breather plate studs deleted and additional parts		RG 7116A	1	
Casing		RG 7116	1	
CASING, main assembly, (when breather plate is fitted) (LC) as with GB 4333A, except		RG 5541A	1	
Casing		RG 5541	1	
Stud, oil pipe clip		KB 3815/Z	1	
CASING, main assembly (when rubber plug is fitted) (LC) as above except breather plate studs deleted and additional parts		RG 7337A	1	
Casing		RG 7337	1	
Plug		RG 7115	1	
CONNECTION, shaft bearing oil supply (RC)	4	RE 10670	1	
COVER, bottom	5	GB 4352	1	
COVER, starter bearing housing	6	GB 3315	1	
COVER, timing inspection	7	GB 4347	1	
ELBOW, trunnion oil supply, upper (ZEO)	8	RF 6778	1	F
ELBOW, trunnion oil supply, upper (ZECO)		RF 7119	1	G
ELBOW, valve trunnion and shaft oil supply (RC)	9	RE 10672	1	
HOUSING, starter bearing assembly, consisting of	10	GB 4351A	1	
Housing		GB 4351	1	
Stud, 2 BA, cover retaining	X.63	KB 254/Z	3	
JOINT, starter motor front	11	RG 4443	1	
JOINT, starter motor rear	12	RG 4456	1	
NUT, full, 3 BA, felt seal bolt	X.21	K 4005/Z	6	
NUT, full, 3 BA, oil pipe clip (LC)		K 4005/Z	1	

GROUP F1 (Continued overleaf)

GROUP F1. CLUTCH CASING (Continued)

NUT, full, 2 BA, starter bearing housing cover	X.21	K 4006/Z	3	
NUT, full, 2 BA, timing inspection cover		K 4006/Z	1	
NUT, full, .312" dia., gearbox	X.21	K 4009/Z	8	
NUT, half, .250" dia., bottom cover	X.24	K 4310/Z	6	
NUT, half, .312" dia., anchor pin	X.24	K 4313/Z	1	
NUT, compression, trunnion oil supply	13	RF 6786	1	
NUT, compression, cross shaft oil supply (LC)		RF 6786	1	
NUT, compression, trunnion oil supply	14	RE 11236	2	G
PIPE, external, trunnion oil supply (RC)		RG 3251	1	F
elbow lower (RC)				
PIPE, clutch trunnion, elbow to straight meter valve (RC)	15	RG 7011	1	G
PIPE, clutch, casing elbow to straight meter valve (RC) or	16	{ RG 7101	1	G
PIPE, clutch, casing elbow to straight meter valve (RC)		{ RG 7010	1	G
PIPE, clutch, trunnion elbow to straight meter valve (RC)	15	RG 7100	1	G
PIPE, oil assembly, clutch trunnion (LC) consisting of	17	RF 8103	1	F
Pipe, tee piece to 3 way junction		RF 8098	1	
Pipe, tee piece to straight meter valve		RF 8104	1	
Pipe, tee piece to trunnion		RF 8099	1	
Tee piece		G 77035	1	
PIPE, oil assembly, clutch trunnion (LC) as above except		RF 8097	1	G
Pipe, tee piece to straight meter valve		RF 8100	1	
or PIPE, oil assembly, clutch trunnion (LC) as above except		RF 8314	1	G
Pipe, tee piece to straight meter valve (LC)	18	RF 8309	1	
PIPE, elbow to straight meter valve (LC) or	19	RG 7037	1	G
PIPE, elbow to straight meter valve (LC)	15	RG 7100	1	G
PIPE, internal, trunnion oil supply assembly, consisting of	20	GB 3238A	1	
Adaptor		GB 3239	1	
Pipe		GP 3238	1	
PLUG, clutch casing (when fitted in place of breather plate)		RG 7115	1	
SCREW, .312" dia., casing to crankcase	X.56	KC 287/Z	2	
SCREW, .437" dia., casing to crankcase	X.58	K 360/Z	4	
SEAL, casing felt	21	GB 4350	1	
SLEEVE, compression, trunnion & shaft oil supply	22	RF 6783	2	F
SLEEVE, compression, trunnion & shaft oil supply	22	RF 6783	4	G
STUD, .250" dia., starter bearing housing with nut K 4008/Z	23	RG 3231	4	
VALVE, meter straight cross shaft oil supply (Z52) (LC)	24	RF 6779	1	

GROUP F1. (Continued overleaf)

GROUP F1. CLUTCH CASING (Continued)

VALVE, meter straight trunnion oil supply (YD 500)	25	RE 11235	1	G
WASHER, adjusting anchor pin	26	GB 3309		B
WASHER, adjusting starter bearing housing .050 thick	27	GB 4349		B
WASHER, adjusting starter bearing housing .075 thick	27	GB 4348		B
WASHER, plain anchor pin, adjacent to Thackeray washer	28	GB 3306	2	
WASHER, plain, 3 BA, felt seal bolt	X.85	K 4404/Z	6	
WASHER, plain, 3 BA, breather plate (where fitted)		K 4404/Z	3	
WASHER, spring, 2 BA, starting bearing housing cover	X.87	K 9006/Z	3	
WASHER, spring, 2 BA, breather plate (where fitted)		K 9006/Z	3	
WASHER, spring, 3 BA, felt seal bolt	X.87	K 9005/Z	6	
WASHER, spring, 3 BA, oil pipe clip (LC)		K 9005/Z	1	
WASHER, spring, .250" dia., bottom cover stud	X.87	K 9008/Z	8	
WASHER, spring, .312" dia., anchor pin	X.87	K 9009/Z	1	
WASHER, spring, .312" dia., casing to crankcase screw		K 9009/Z	2	
WASHER, spring, .312" dia., gearbox stud		K 9009/Z	8	
WASHER, spring, .437" dia., casing to crankcase screw	X.87	K 9011/Z	4	
WASHER, Thackeray, 2 BA, timing inspection cover stud	X.90	K 3803/Z	1	
WASHER, Thackeray, .250" dia., starter bearing housing stud	X.90	K 3804/Z	4	
WASHER, Thackeray, .500" dia., anchor pin bush	X.90	K 3808/Z	1	

GROUP F2. CLUTCH

Comprising

CLUTCH, 10" Borg and Beck, consisting of		GB 4421	1	F
Cover assembly	1	RG 7067	1	
Plate, driven assembly	2	RG 7066	1	
CLUTCH, 11" Borglite, consisting of		RE 11541	1	J
Cover assembly		RG 7071	1	
Plate, driven assembly		RG 7070	1	
CLUTCH, 11" consisting of		RG 3386	1	K
Cover assembly		RG 7069	1	
Plate, driven assembly		RG 7068	1	

GROUP F3. LINKAGE

Comprising

BOLT, .250" dia., anchor bracket to frame retaining	X.10	K 205/Z	2	
BRACKET, anchor	1	GB 3620	1	

GROUP F3. (Continued overleaf)

GROUP F3. LINKAGE (Continued)

BRACKET, intermediate lever	2	GB 5037	1
BUSH, stay to swivel bracket	3	GB 4751	1
COLLAR, flanged bearing anchor bracket	X.16	KB 1180/Z	1
JAW, adjustable, pull rod, cross shaft lever end R.H. thread	X.17	KB 1114/Z	1
JAW, adjustable, pull rod, intermediate lever end L.H. thread	4	CW 2137	1
LEVER, intermediate, assembly, consisting of	5	GB 5038A	1
Bearing spherical		GB 1451	1
Bush		GB 3615	2
Lever		GB 5038	1
Washer		GB 1450	1
LEVER, inter, ride control assembly (LC) consisting of	6	RG 6125A	1
Bush		RG 5100	1
Pin ball		RE 3527	1
LINK, bottom, intermediate lever to pedal	7	GB 4753	1
NUT, full, .250" dia., anchor bracket bolt	X.21	K 4008/Z	2
NUT, half, .312" dia., stay to bracket retaining	X.24	K 4313/Z	1
NUT, lock, .312" dia., pull rod jaw, L.H. thread	X.22	KB 5054/Z	1
NUT, lock, .312" dia., pull rod jaw, R.H. thread	X.24	K 4313/Z	1
PIN, bearing bottom link, both ends	8	RG 4406	2
PIN, bearing, intermediate lever fulcrum (RC)	9	RG 4407	1
PIN, bearing, intermediate lever fulcrum (LC)	10	RG 5766	1
PIN, bearing, intermediate lever pull rod	11	RG 4405	1
PIN, bearing, flange swivel bracket to anchor bracket	X.30	KB 4569/Z	1
PIN, split, .125" dia., bearing pins	X.31	K 4643/Z	5
ROD, pull, clutch adjusting	12	GB 3617	1
STAY, thrust	13	GB 4752	1
WASHER, adjusting	14	GB 3309	B
WASHER, plain, to stay bush on swivel bracket	15	GB 3306	2
WASHER, spring, .250" dia., anchor bracket bolt	X.87	K 9008/Z	2
WASHER, spring, operating lever	X.87	K 9009/Z	1
WASHER, spring, bracket stay		K 9009/Z	1
WASHER, Thackeray, .500" dia., stay to swivel bracket	X.90	K 3808/Z	1

GROUP F4. PEDAL

Comprising

BOLT, .312" dia., pedal holder to pedal lever	X.11	K 309/Z	1
BUSH, clutch operating lever fulcrum (RC)	1	FB 3392	2
BUSH, operating lever fulcrum (LC) (combined shaft clutch and brake)	2	RF 6333	4
COLLAR, pedal return spring anchor (RC)	X.16	KB 1179/Z	1
CUP, anti-fume seal	3	RF 8328	1
HOLDER, pedal upward stop	4	FB 4455	2

GROUP F4. (Continued overleaf)

GROUP F4. PEDAL (Continued)					
LEVER, clutch operating assembly, consisting of	5	FB 4940A	1		
		(RC)			
Lever		FB 4940	1		
Pin, spring anchor		FB 4713	1		
LEVER, pedal clutch (LC)	6	RF 6543	1		
LINK, clutch pedal spring (LC)	7	RG 5050	1		
NUT, full, .312" dia., pedal holder to pedal					
		lever			
NUT, full, .375" dia., pedal shaft (RC)	X.21	K 4009/Z	1		
NUT, half, 3 BA, anti-fume seal	X.21	K 4010/Z	2		
NUT, lock, .500" dia., combined shaft (LC)	X.24	K 4304/Z	2		
NUT, lock, .500" dia., combined shaft (LC)	X.24	K 4322/Z	2		
PEDAL, assembly, consisting of (RC)	8	RF 5853	1		
Holder		RF 5851	1		
Pad, rubber		RF 4281	1		
Plate		FB 3769	1		
PEDAL assembly (LC) as above except for pedal	9	RF 8022A	1		
PLATE, pedal gap, (RC)	10	RF 3593	1		L
PLATE, pedal gap, (RC)		RF 6706	1		M
PLATE, pedal gap, (LC)	11	RF 6407	1		
PLATE, backing, pedal gap plate	12	RF 6165	3		
PIECE, distance, anti-fume seal	13	F 61510	2		
PIN, split, .062" dia., pedal return spring					
		anchor (RC)			
RETAINER, anti-fume seal	X.31	K 4602/Z	1		
SCREW, cheese head, 3 BA, gas tight joint	14	F 61548	1		
SCREW, cheese head, 3 BA, gas tight joint	X.45	K 1816/N	2		
SHAFT, pedal (RC)	15	FB 3662	1		
SHAFT, pedal (LC) (combined shaft clutch & brake)	16	RF 6332	1		
SPRING, anti-fume seal	17	F 60920	1		
SPRING, pedal return (RC)	18	FB 4707	1		
SPRING, pedal return (LC)	19	GB 5097	1		
STOP, pedal downwards rubber	20	FW 1597	1		B
STOP, pedal downwards rubber		FW 5854	1		
STOP, pedal upwards rubber	21	FB 4457	1		
WASHER, felt, anti-fume seal	22	FB 472	1		
WASHER, pedal lever boss large dia. bore (RC)	23	RF 3391	1		
WASHER, pedal lever boss small dia. bore (RC)	24	RF 3390	1		
WASHER, plain, retainer felt screw	X.85	K 4446/Z	2		
WASHER, plain, .500" dia., pedal lever shaft (LC)	X.84	KB 3909/Z	2		
WASHER, plain, pedal lever boss (LC)	25	RF 7024	1		or 2 to suit
WASHER, plain, pedal lever boss (LC)		RF 7025	1		or 2 to suit
WASHER, plain, pedal lever boss (LC)		RF 7026	1		or 2 to suit
WASHER, plain, pedal lever boss (LC)		RF 7027	1		or 2 to suit
WASHER, plain, pedal lever boss (LC)		RF 7028	1		or 2 to suit
WASHER, plain, pedal lever shaft (LC)	26	EB 4623	2		
WASHER, rubber, pedal lever (LC) 1.125" dia.	27	RF 6408	2		
WASHER, spring, 3 BA, anti-fume seal	X.87	K 9005/Z	2		
WASHER, spring, .312" dia., pedal holder	X.87	K 9009/Z	1		
WASHER, spring, .375" dia., pedal shaft nuts (RC)	X.87	K 9010/Z	2		
WASHER, spring, .500" dia., pedal lever shaft (LC)	X.87	K 9012/Z	2		

GROUP F5. TRUNNION AND CROSS SHAFT

Comprising

BEARING, ball, Hoffman	1	RG 5431	1	A
BEARING, ball, Fischer		RG 7083	1	A
BEARING, ball, Ransom and Marles		RG 6590	1	A
BOLT, .312" dia., lever boss	X.11	K 314/Z	1	
HOUSING, ball bearing	2	GB 4083	1	
JOINT, trunnion oil trough	3	GB 4081	1	
KEY, Woodruff, .125" wide, cross shaft lever	X.18	KC 505		A
KEY, Woodruff, .1255" wide, cross shaft lever		KC 506		A
KEY, Woodruff, .126" wide, cross shaft lever		KC 507		A
KEY, Woodruff, .127" wide, cross shaft lever		KC 508		A
LEVER, cross shaft, actuating assembly, consisting of	4	GB 4756A	1	H
Bearing, spherical		GB 1451	1	
Lever		GB 4756	1	
Washer, spherical seated		GB 1450	1	
LEVER, cross shaft actuating assembly, as above except for lever		GB 3619	1	N
NUT, full, .312" dia., lever boss	X.21	K 4009/Z	1	
PIN, bearing, cross shaft spherical bearing	5	RG 4405	1	
PIN, split, .093" dia., shaft arms in universal ring retaining	X.31	K 4608/Z	2	
PIN, split, .125" dia., cross shaft, spherical bearing pin	X.31	K 4643/Z	2	
PIN, split, .125" dia., bracket to frame	X.31	K 4643/Z	1	
PIN, split, .125" dia., universal, ring in trunnion retaining	X.31	K 4613/Z	2	
RING, dished, ball bearing retaining	6	GB 2084	1	
RING, spring, ball bearing retaining	7	GB 2085	1	
RING, universal	8	G 83321	1	
SCREW, 3 BA, oil trough retaining	X.53	KC 101	2	
SHAFT, cross assembly, consisting of (RC)	9	GB 4422A	1	
Disc		F 86825	1	
Shaft		GB 4422	1	
SHAFT, cross assembly as above, except shaft (LC)		GB 5764A	1	
TROUGH, oil trunnion	10	GB 4082	1	
TRUNNION, housing	11	GB 4084	1	
WASHER, 3 BA, trunnion oil trough screw	X.87	K 9005/Z	2	
WASHER, spring, .312" dia., lever boss	X.87	K 9009/Z	1	

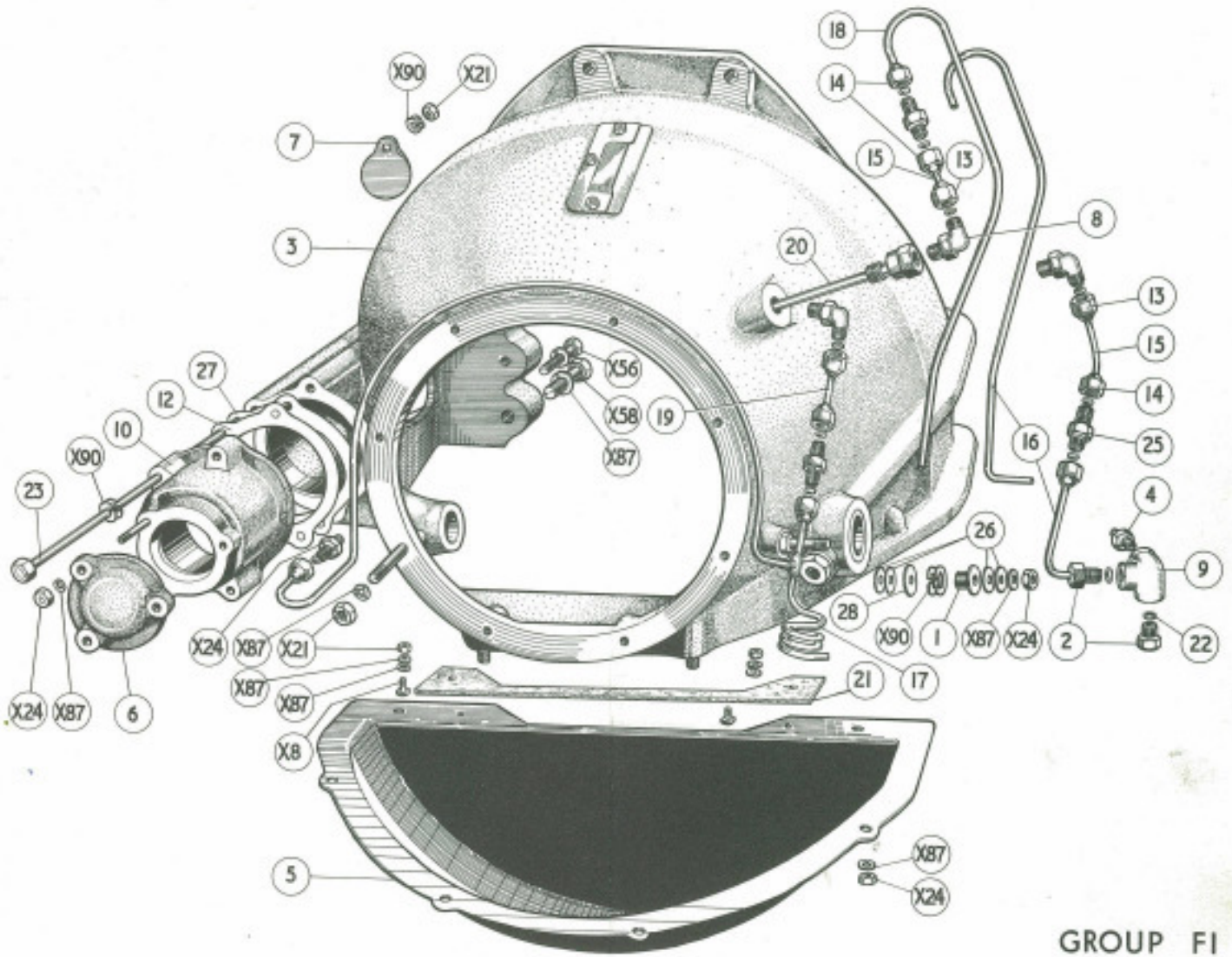

GROUP FI



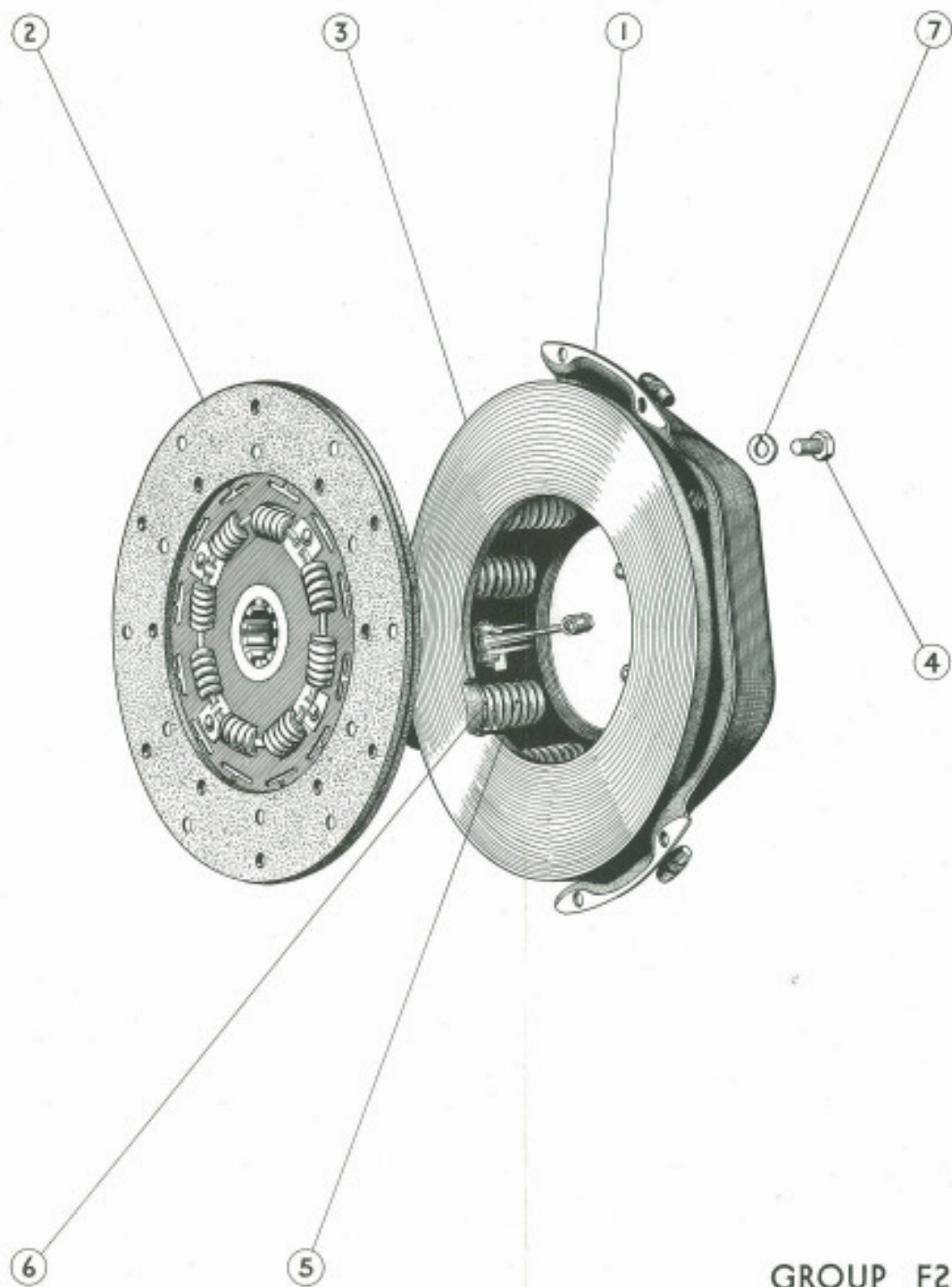

GROUP F2



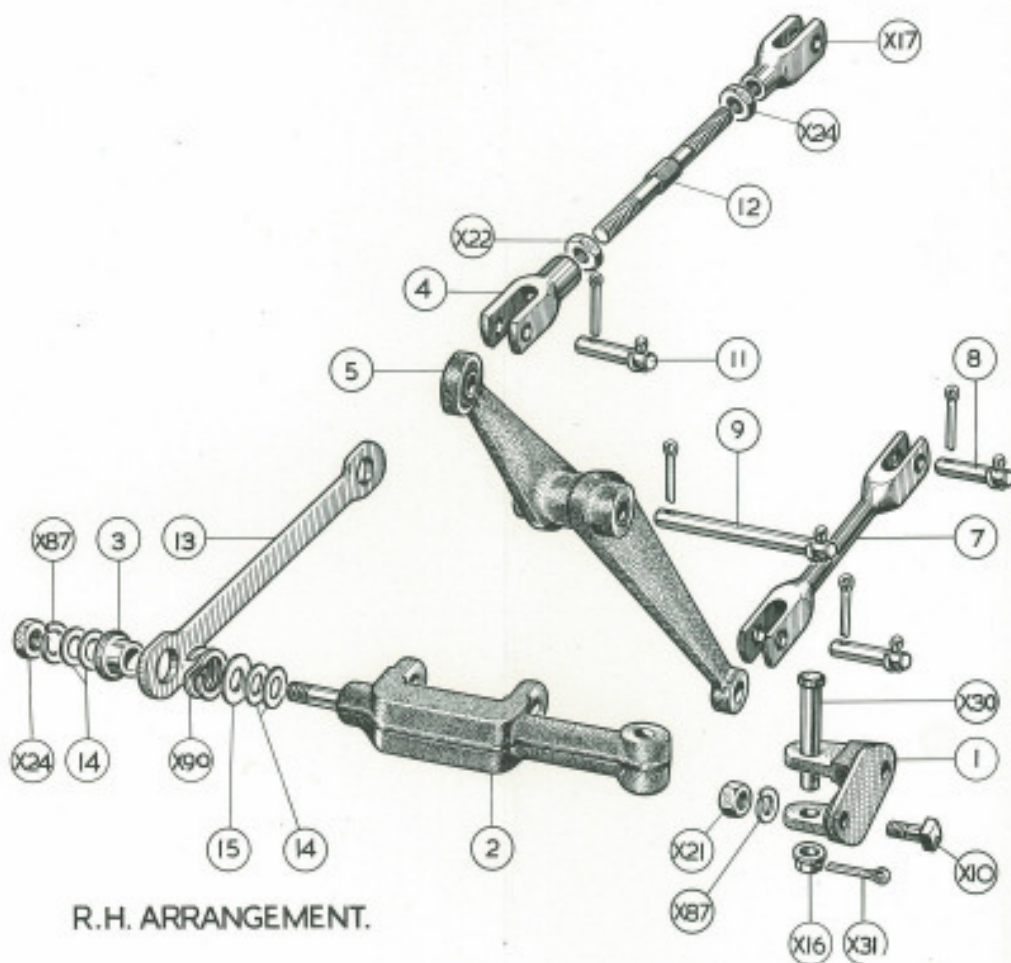

R.H. ARRANGEMENT.

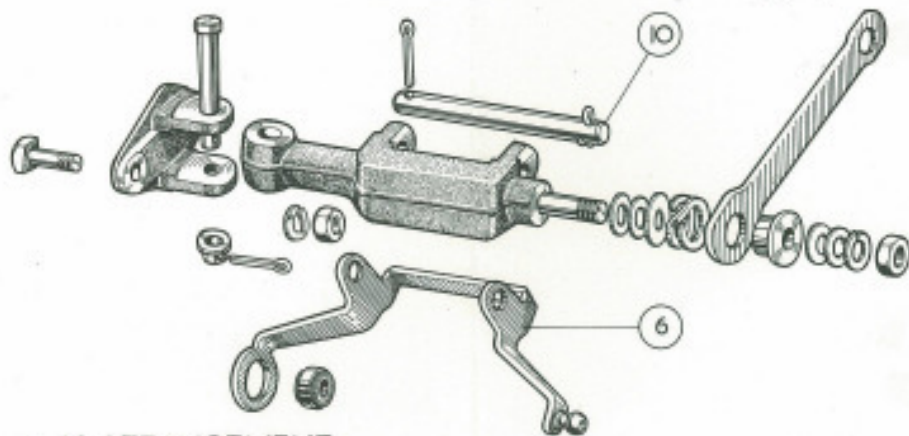

L.H. ARRANGEMENT.

GROUP F3



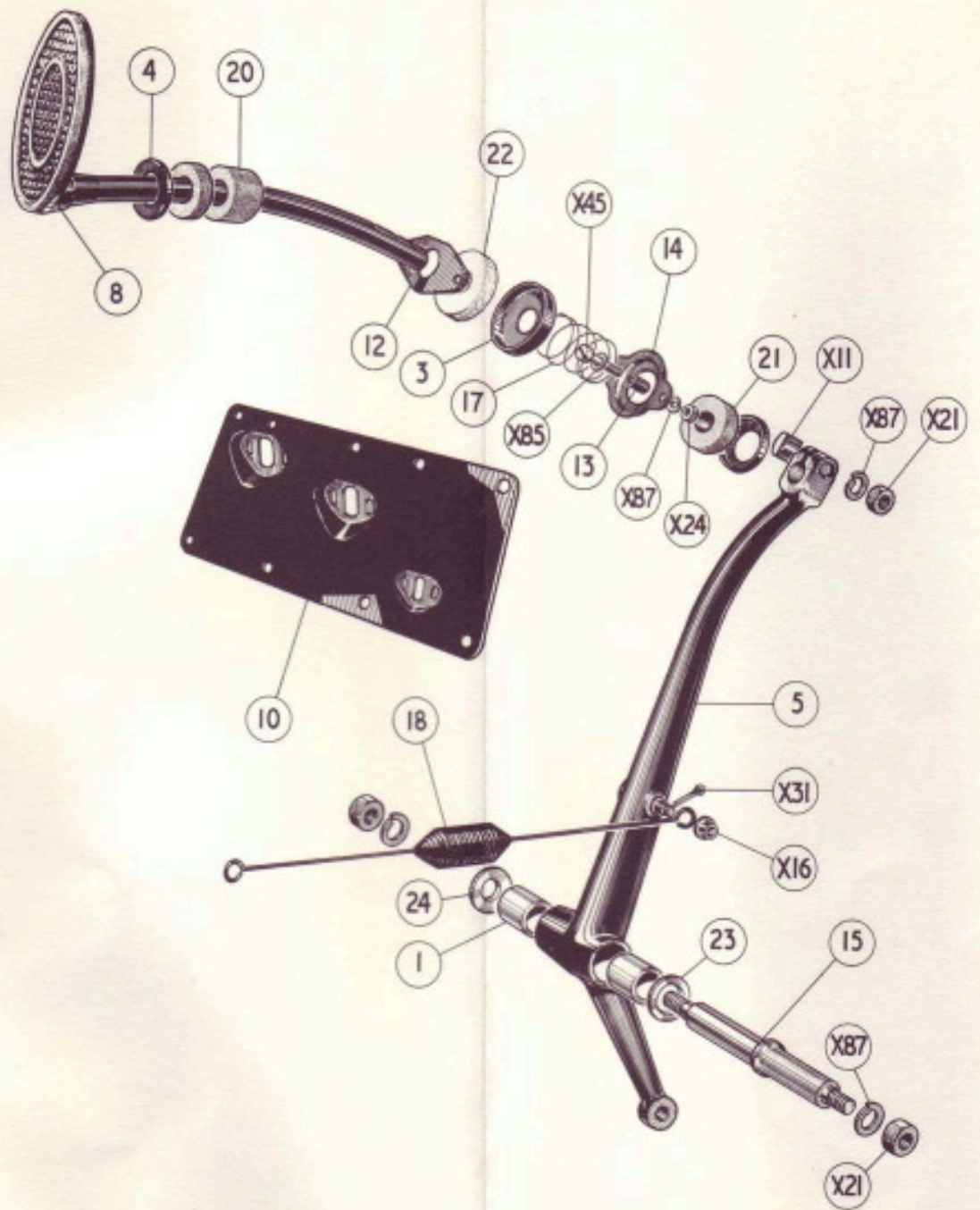

GROUP F4



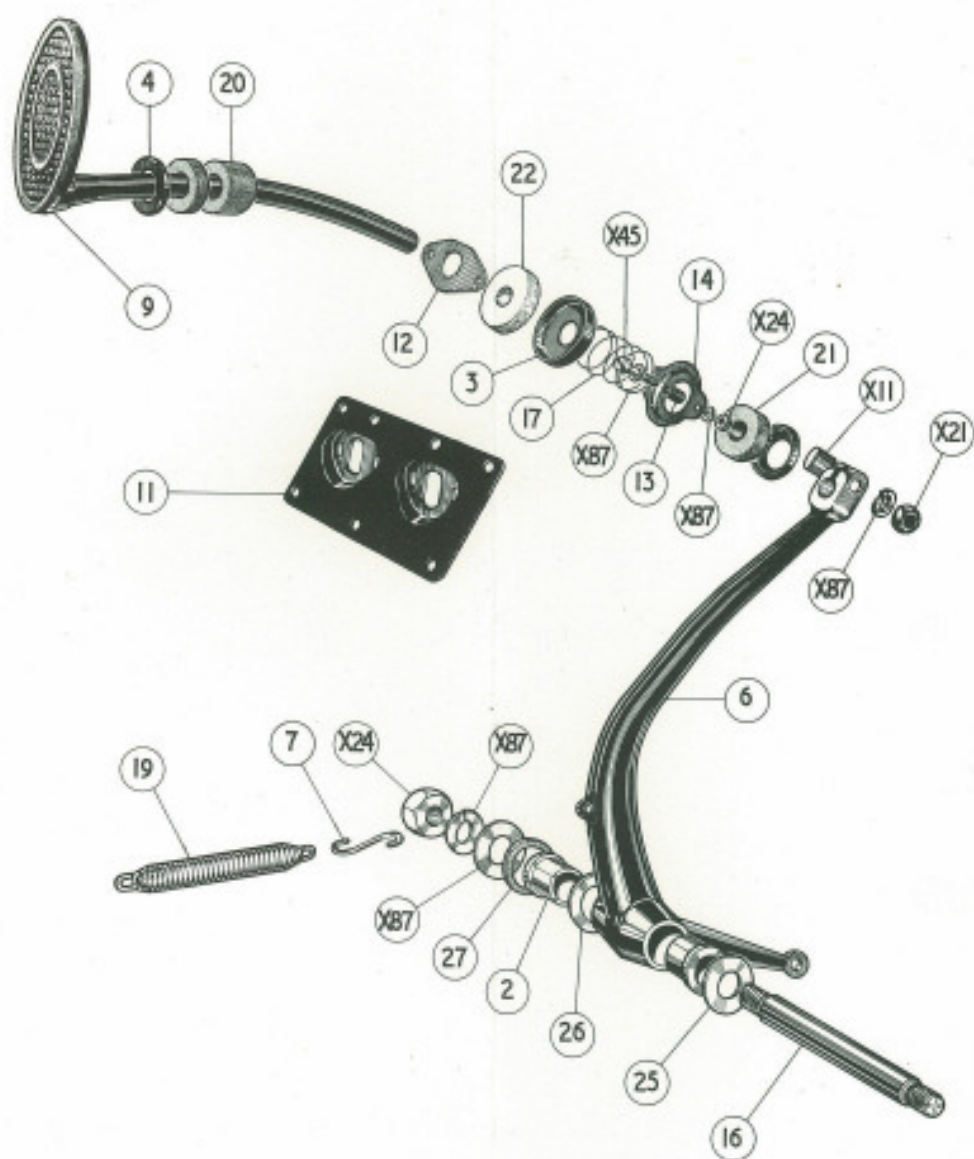

GROUP F4



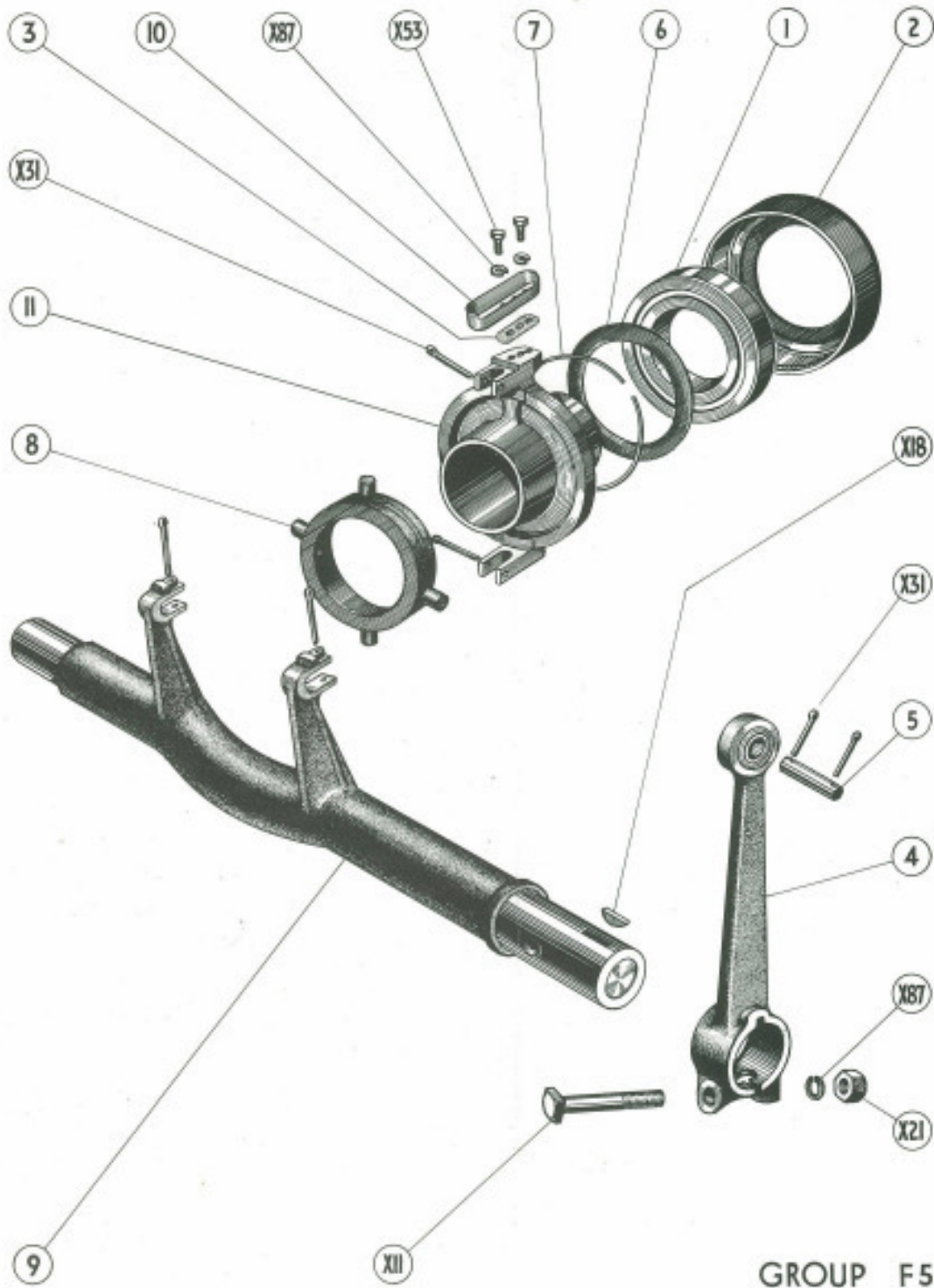

GROUP F5

