

## GROUP G8. SERVO MOTOR DRIVE.

Comprising:

BEARING, ball, inner	1	RG. 7079	1	A
BEARING, ball, inner		RG. 4449	1	A
BEARING, ball, inner		RG. 6588	1	A
BEARING, ball, outer	2	RG. 4448	1	A
BEARING, ball, outer		RG. 7078	1	A
BEARING, ball, outer		RG. 6587	1	A
CIRCLIP, Seegar, outer bearing	3	KB. 14188	1	
CIRCLIP, Seegar, worm wheel	4	KB. 14172	1	
HOUSING, oil seal	5	RG. 3109	1	
JOINT, oil seal housing	6	RG. 3000	1	
NUT, castellated, .437" dia., shaft retaining	X.20	KB. 3589	1	
PIN, Servo driving	7	RG. 3222	3	
PIN, split, .093" dia., shaft nut	X.31	K. 4608	1	
SCREW, countersunk head, 2 BA., housing	X.50	K. 2810	4	
SEAL, oil, Angus, "Gacc"	8	RG. 7027	1	
SHAFT,	9	RG. 3246	1	
WASHER, inner bearing	10	GB. 4043	1	
WASHER, worm wheel	11	RG. 3705	1	
WHEEL, worm	12	RG. 3419	1	

## GROUP G9. THIRD MOTION SHAFT.

Comprising:

BALL, steel, .187" dia., supporting 3rd to 4th speed sliding piece key, to suit key, RG.2138		RG.6953	4	A/V
BALL, steel, .187" dia., supporting 3rd to 4th speed sliding piece key, to suit key, RG.2138		RG.6209	4	A/V
BALL, steel, .312" dia., 1st speed gear		RG.6594	2	A
BALL, steel, .312" dia., 1st speed gear		RG.6131	2	A
BEARING, ball, centre	2	RG. 4447	1	A
BEARING, ball, centre		RG. 7076	1	A
BEARING, ball, centre		RG. 6595	1	A
BEARING, ball, rear	3	RG. 5959	1	A
BEARING, ball, rear		RG. 6592	1	A
BUSH, large dia. flange, 2nd & 3rd speed gears	4	RG. 6984	2	
BUSH, small dia. flange, 2nd & 3rd speed gears	5	RG. 6983	2	
CONE, synchromesh, 2nd speed assembly	6	RG. 3245	1	
CONE, synchromesh, 3rd speed assembly	7	RG. 3243	1	T
CONE, synchromesh, 3rd speed assembly		RG. 4280	1	U
FLANGE, rear coupling	8	RG. 3121	1	
GEAR, 21 teeth, 3rd speed, driven	9	RG. 100	1	
GEAR, 28 teeth, 1st speed, gear	10	RG. 3221	1	
GEAR, 30 teeth, 2nd speed, driven	11	RG. 179	1	
GEAR, worm, Servo drive	12	RG. 3418	1	
KEY, 1st speed gear	13	GB. 5391	1	
KEY, locating, 3rd speed gear	14	GB. 5359	1	
KEY, 3rd to 4th speed sliding piece to suit shaft, RG.193		RG.2138	2	V

GROUP G9. (Continued Overleaf)



## GROUP G9. THIRD MOTION SHAFT (Continued).

KEY, 3rd to 4th speed sliding piece, to suit shaft, RG.5469	15	RG.5471	2	W
NUT, rear flange	16	G.54923	1	
PIECE, sliding, 3rd to 4th speeds to suit shaft RG.193, assembly consisting of:		RG. 102A	1	T
Piece, sliding		RG. 102	1	
Rivet		RG.2139	2	
PIECE, sliding, 3rd to 4th speed as above, except:		RG.4279A	1	Z
Sliding piece		RG.4279	1	
PIECE, sliding, 3rd to 4th speed to suit shaft, RG.5469	17	RG.5470	1	W
PIN, locating, 3rd speed gear	18	RG.3128	1	
PLUNGER, supporting, sliding piece key	19	RG.7009	4	W
SHAFT, 3rd motion (supersedes RG.193, not supplied as a replacement)	20	RG.5469	1	W*
SLEEVE, 3rd speed gear and centre bearing	21	GB.5374		
SPRING, 1st speed gear	22	GB.4875	2	
SPRING, 3rd speed gear, locating pin	23	GB.3408	1	
SPRING, supporting, .187" dia., steel balls	24	GB.4842	2	
WASHER, adjusting, centre bearing	25			
.150" thick, GB.5366 .152" thick, GB.5368				
WASHER, adjusting, centre bearing				
.154" thick, GB.5370 .156" thick, RG.3496				
.158" thick, RG.3497 .160" thick, RG.3371				
WASHER, adjusting, 2nd speed gear	26			
.178" thick, RG.3498 .175" thick, GB.5361				
.177" thick, GB.5363 .179" thick, GB.5365				
WASHER, adjusting, rear flange	27			
.040" thick, RG. 645 .045" thick, RG.6416				
.050" thick, RG.6417 .055" thick, RG.6418				
.060" thick, RG.6419 .065" thick, RG.6420				
.070" thick, RG.6554 .075" thick, RG.6555				
.080" thick, RG.6556 .085" thick, RG.6557				
.090" thick, RG.6558 .095" thick, RG.6559				
.100" thick, RG.6560 .105" thick, RG.6561				
.110" thick, RG.6562 .115" thick, RG.6563				
WASHER, key, 3rd speed gear	28	RG.7392	1	
WASHER, lock, rear flange nut	29	G.54681	1	
WASHER, plain, rear flange	30	G.54680	1	
WASHER, worm to 2nd speed gears				
.325" thick, RG.4350 .345" thick, RG.4351				
.365" thick, GB.5371 .385" thick, RG.4352				
.405" thick, RG.4353 .425" thick, RG.4354				

\*NOTE: When shaft RG.5469 is used to replace RG.193 parts marked "W" must also be supplied.



## GROUP G10. TIE BAR.

Comprising:-

BLOCK, rubber	1	RG. 3428	4
BOLT, .250" dia., tie rod brackets	X.10	K. 243/Z	3
BRACKET assembly, consisting of:	2	RG. 5939	1
Bracket		RG. 5883	1
Cup for rubber block		RG. 3431	2
Rivet, .125" dia.		KB. 2454	6
NUT, half, .250" dia. bracket to frame bolt	X.24	K. 4310/Z	3
NUT, lock, .375" dia.	X.24	K. 4316	7
PIECE, distance, between rubber blocks	2	RG. 3429	2
PLATE, packing	4	RG. 3434	1
ROD	5	RG. 3430	1
SEATING	6	RG. 3427	1
WASHER, pressure	7	F. 88553	4
WASHER, spring, .250" dia., bracket bolt	X.87	K. 9008/Z	3

-----

## GROUP G1

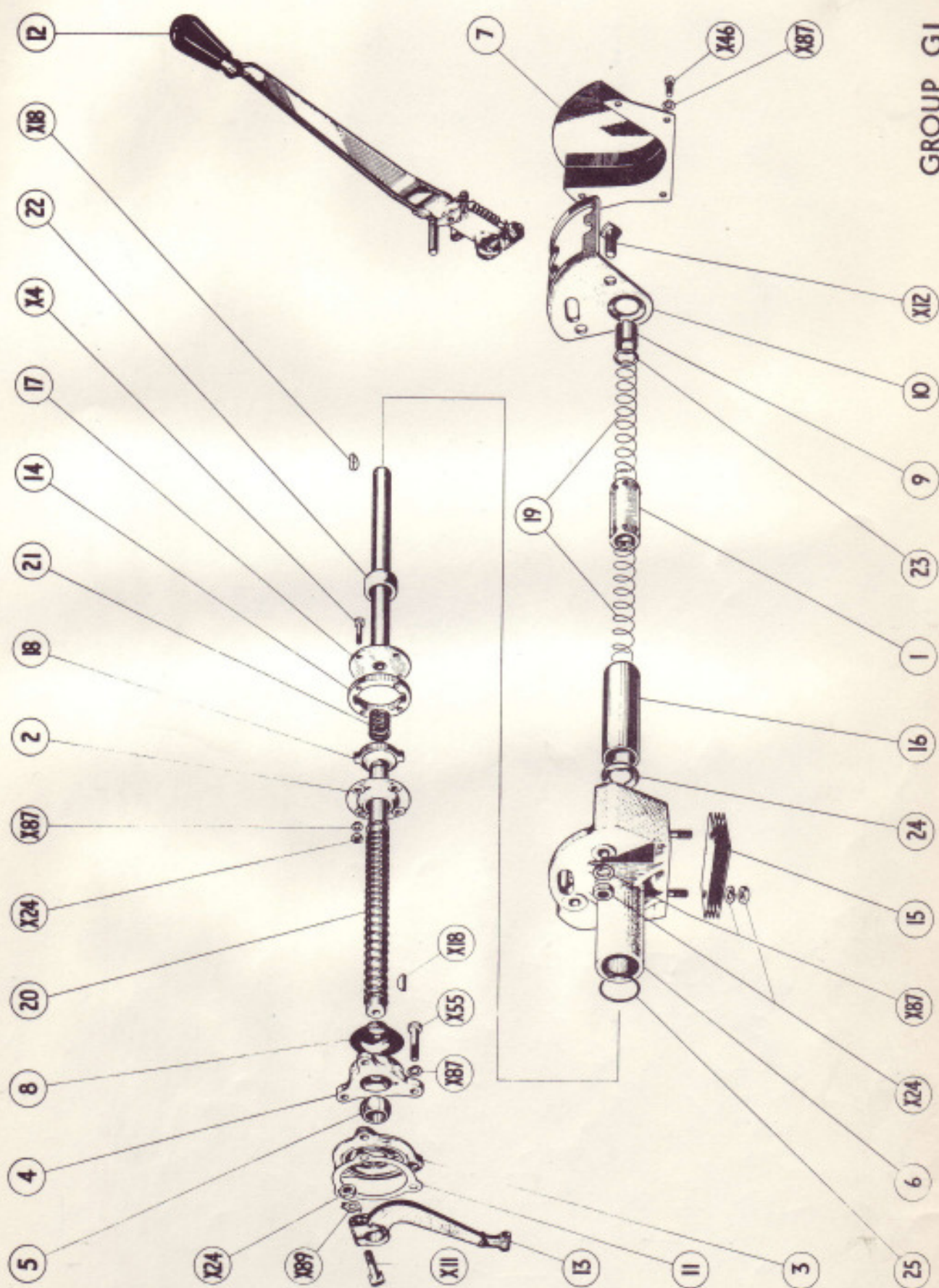



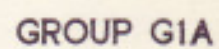



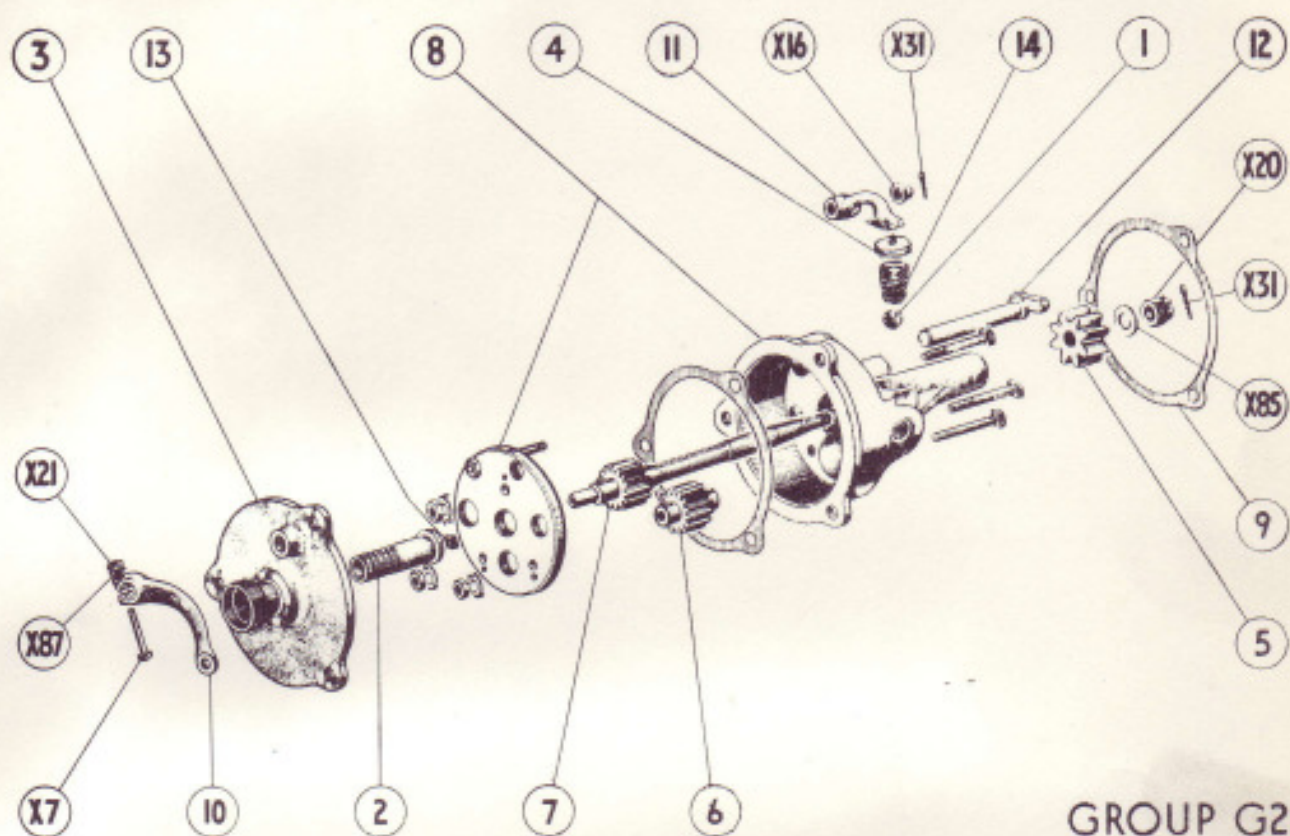

GROUP G2

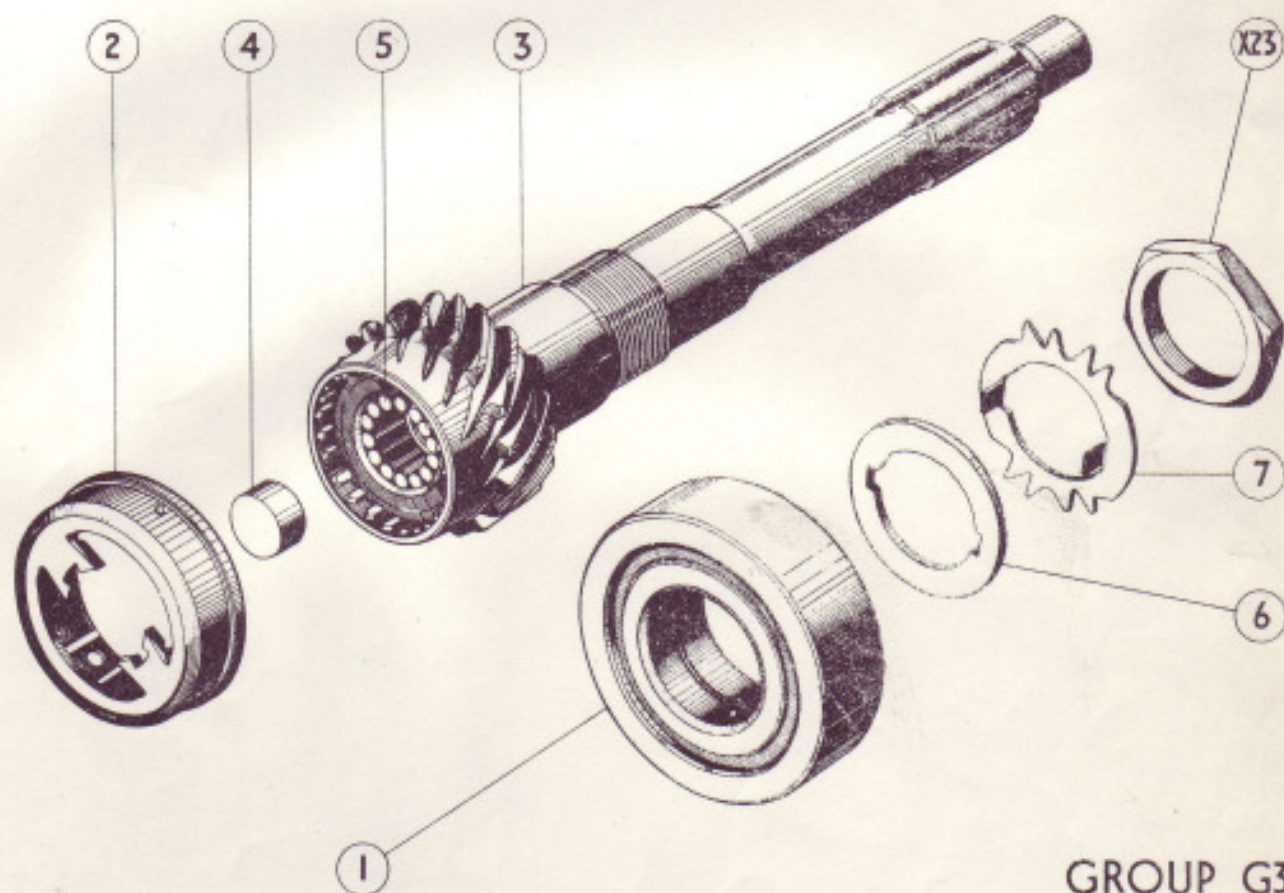

GROUP G3





GROUP G4

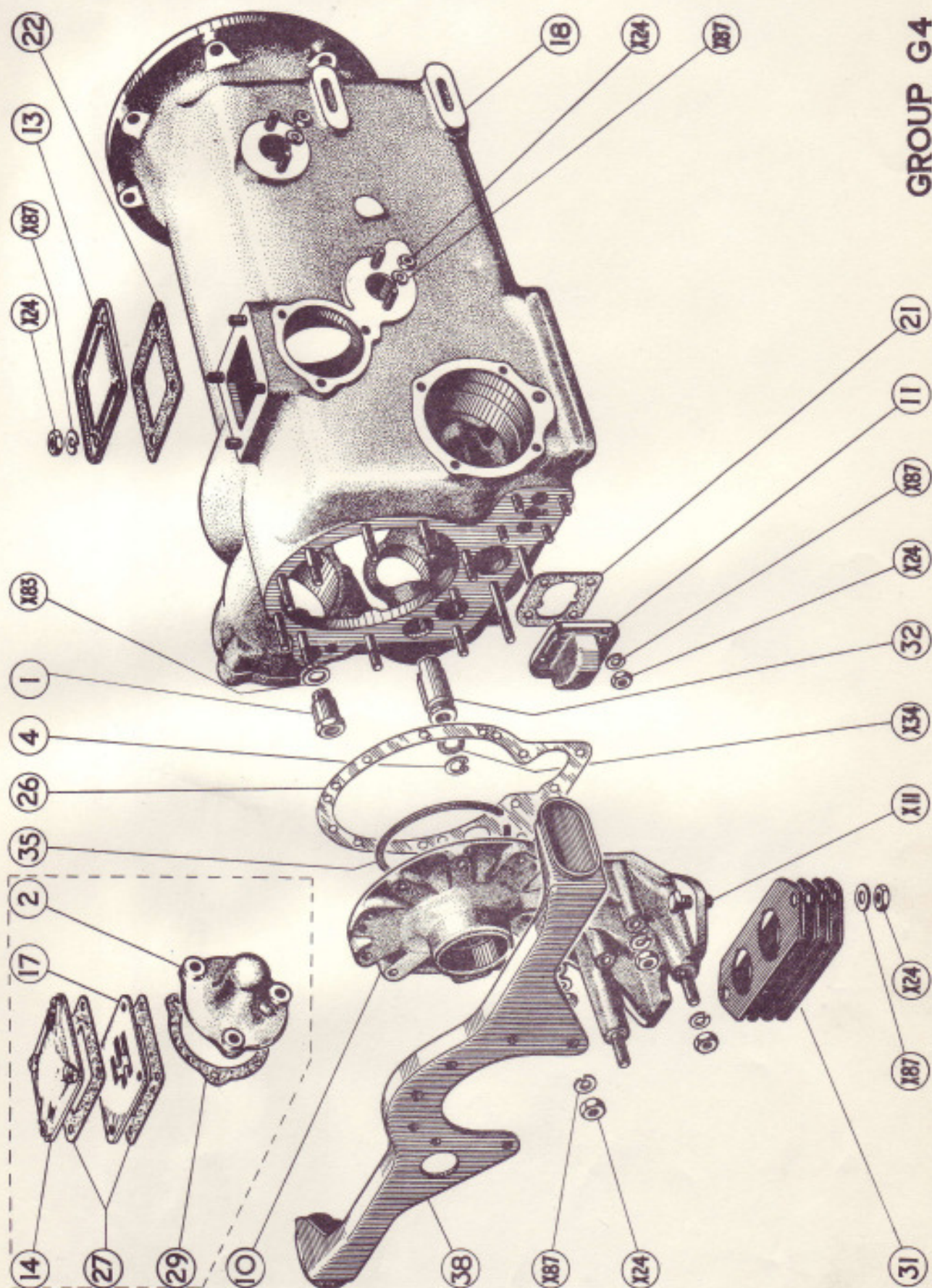



## GROUP G4

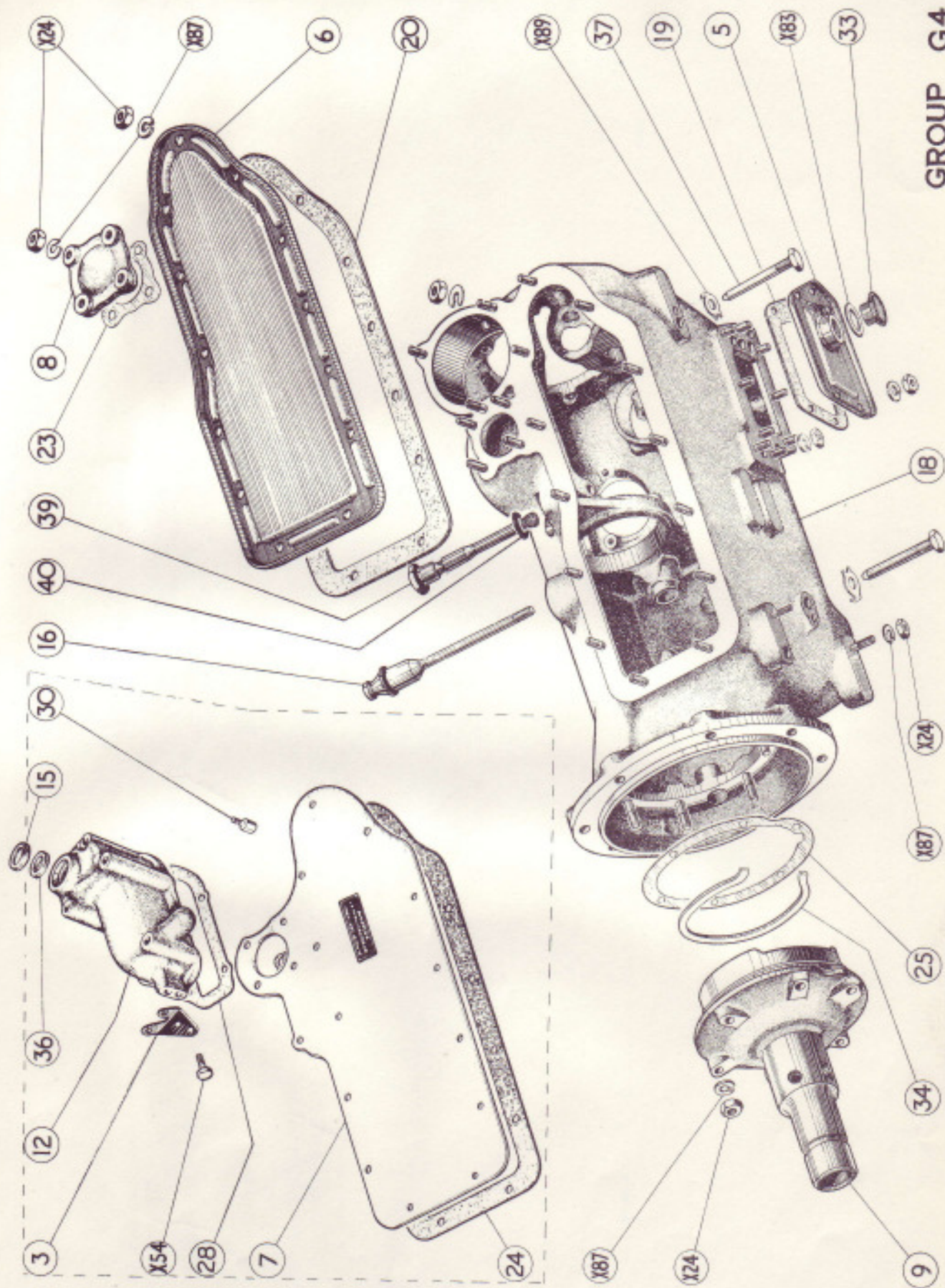



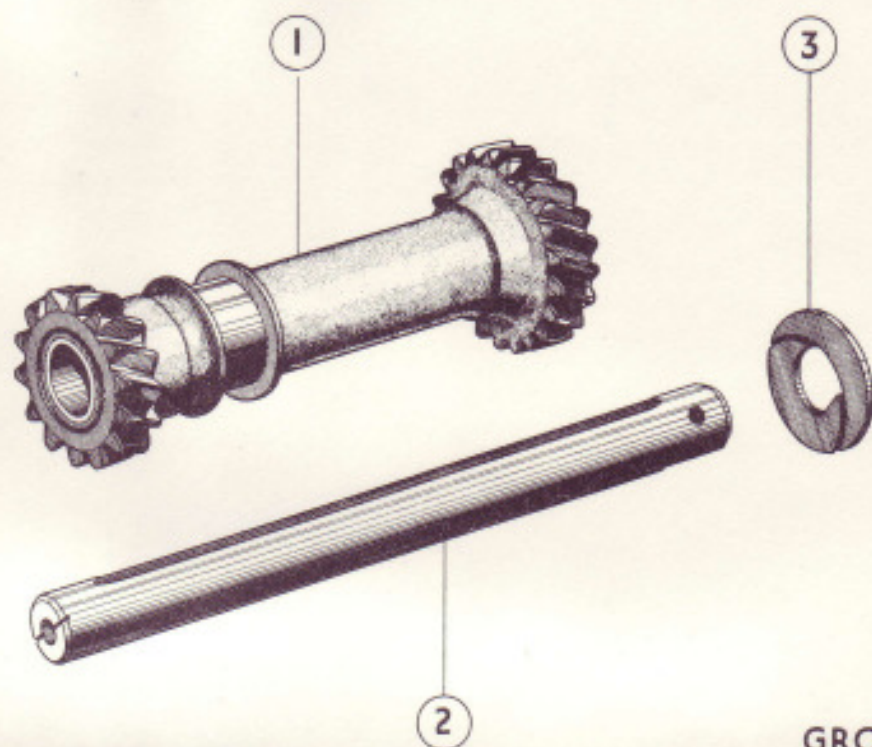

GROUP G5

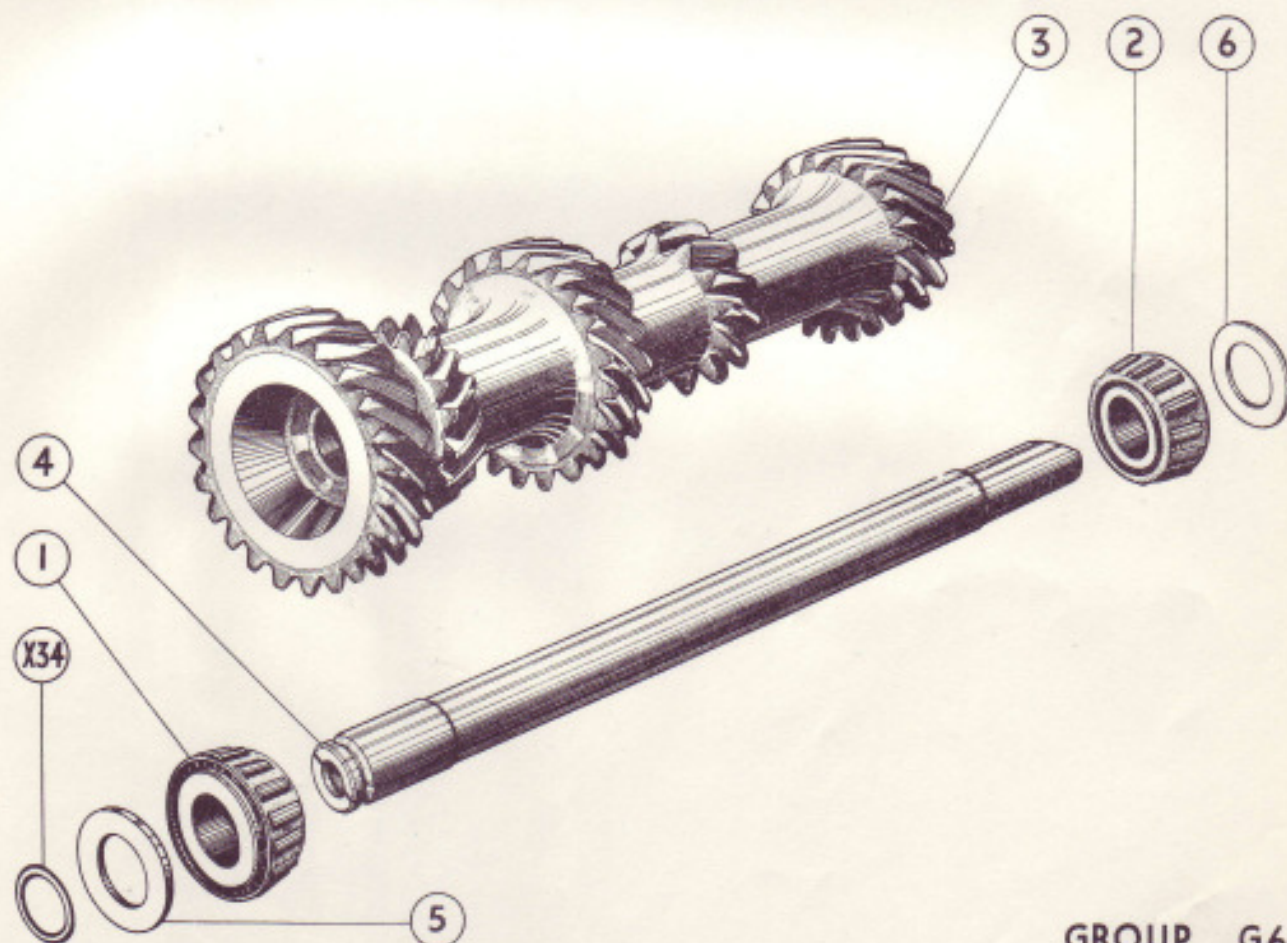

GROUP G6





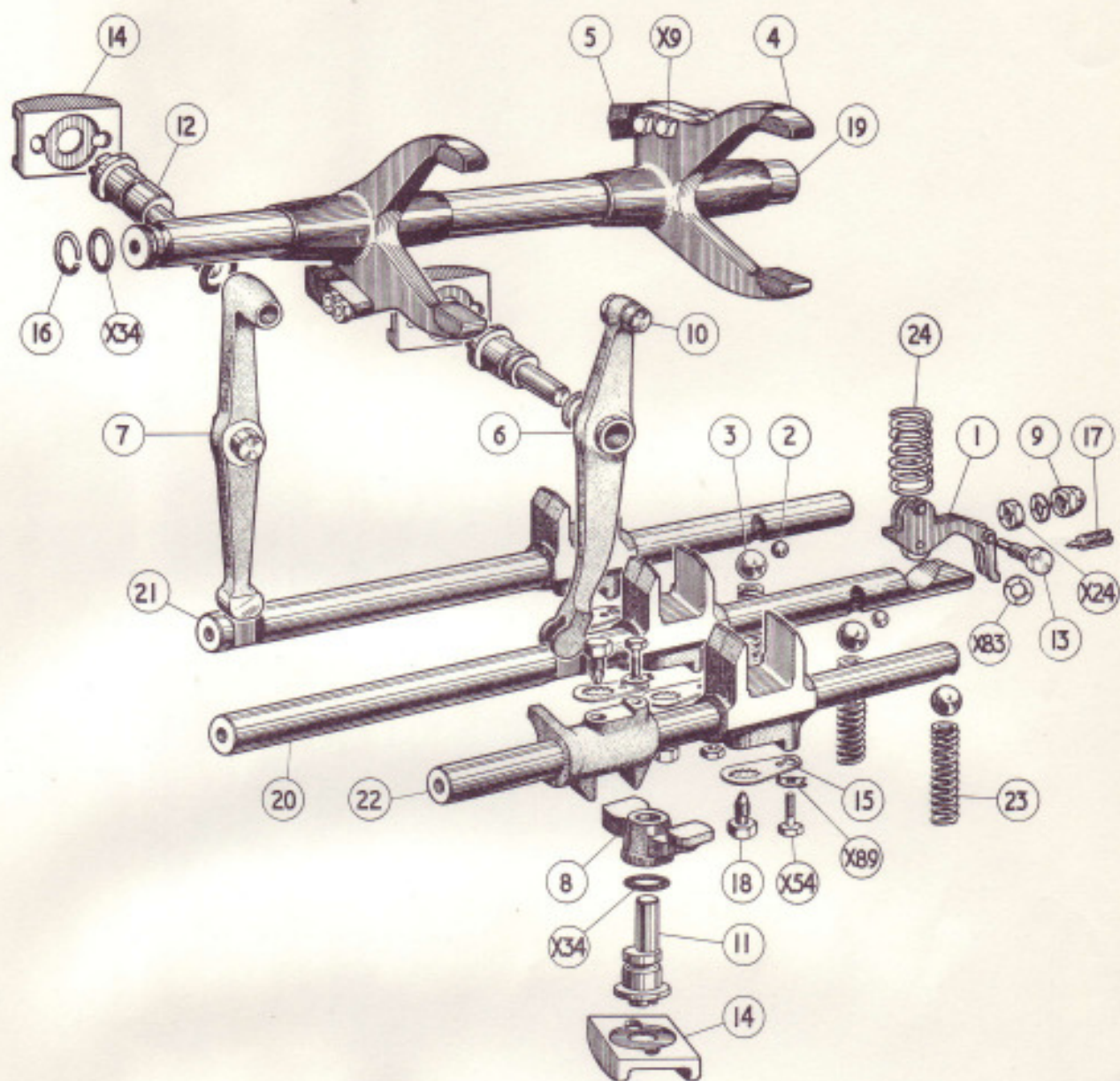

GROUP G 7





## GROUP G8

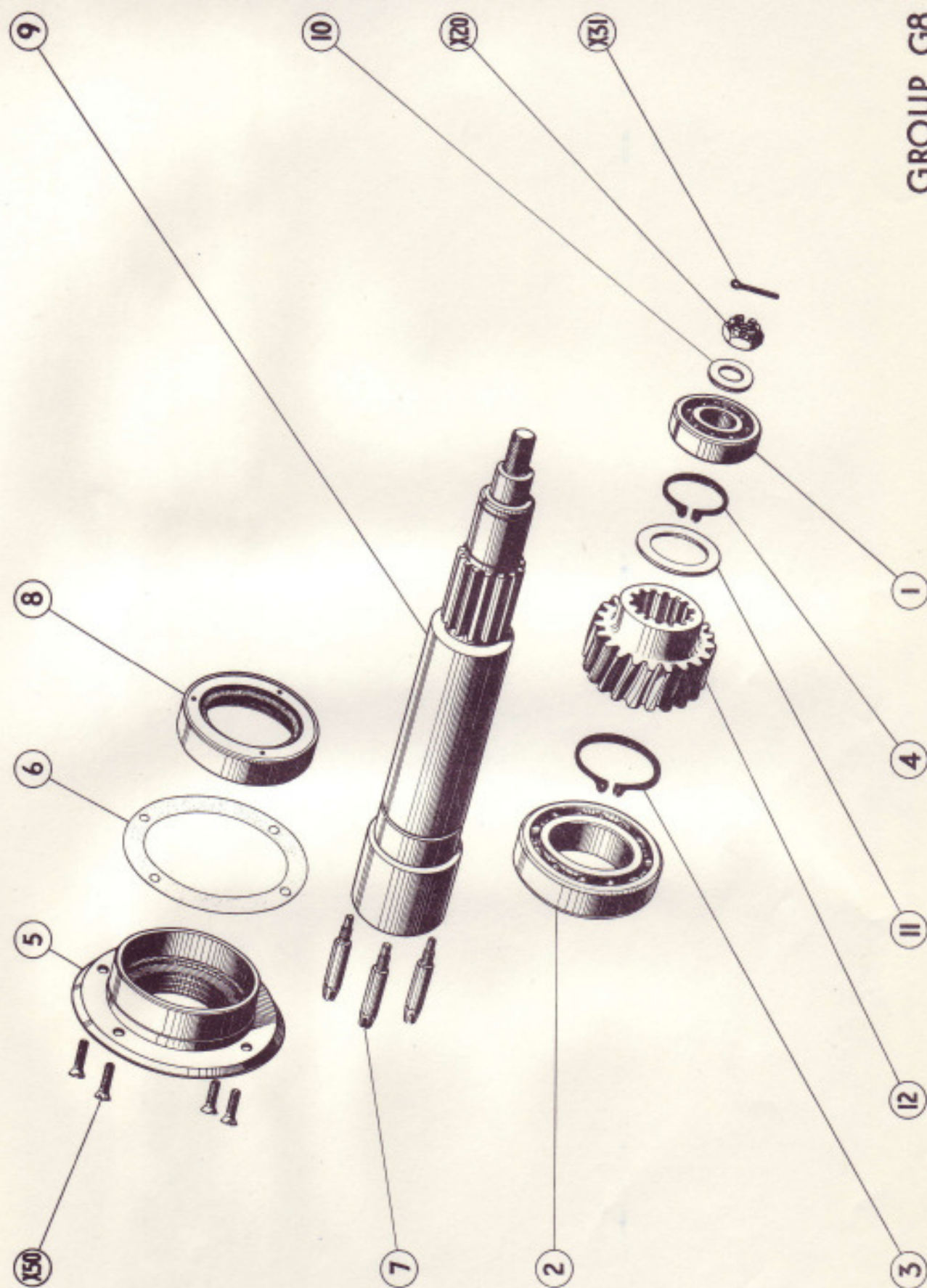



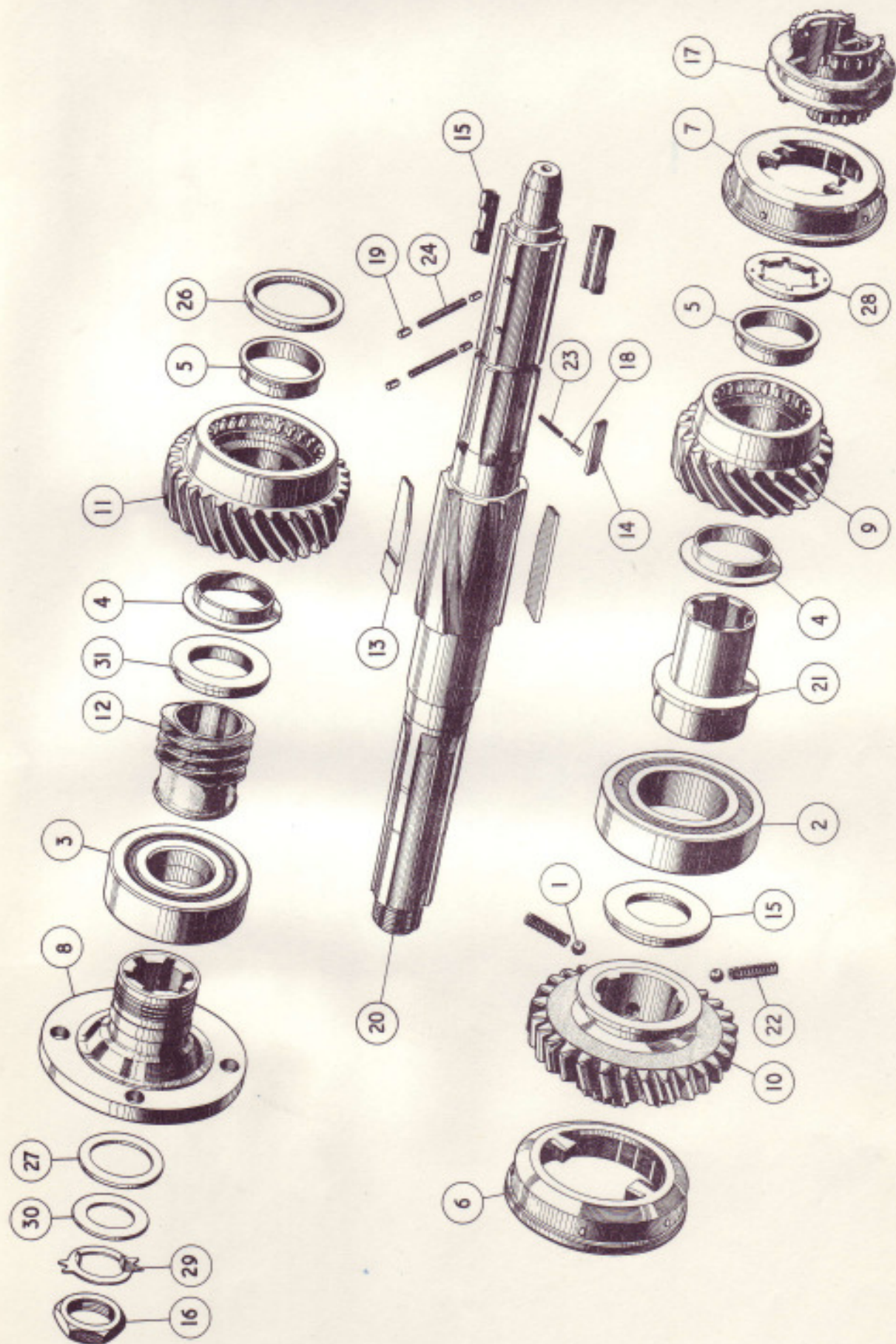



GROUP GIO

